

ENGLISH  
ESPAÑOL



# TRUPER®

Manual

## Electric string trimmer/edger

**550 W**

Power

**DES-550**

Applies for:

Code	Model
101263	DES-550

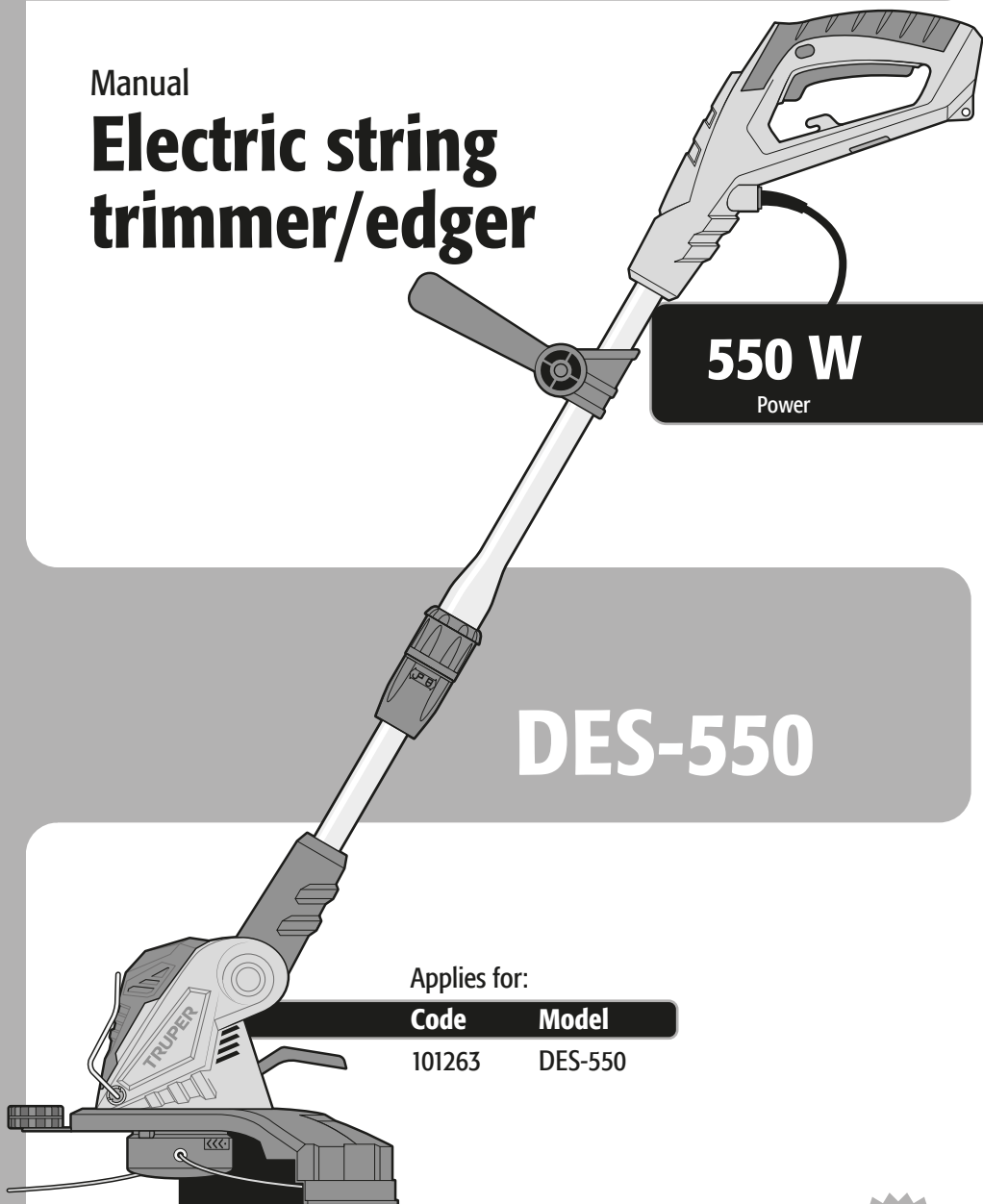

**CAUTION**



Read this manual thoroughly  
before using the tool.



Technical Data .....	<b>3</b>
Power Requirements .....	<b>3</b>
 General power tool safety warnings .....	<b>4</b>
 Safety warnings for string trimmers .....	<b>5</b>
Parts .....	<b>6</b>
Assembly .....	<b>7</b>
Start Up .....	<b>8</b>
Maintenance .....	<b>10</b>
Troubleshooting .....	<b>10</b>
Authorized Service Centers .....	<b>11</b>
Warranty Policy .....	<b>12</b>

## **CAUTION**

To gain the best performance of the tool, prolong the duty life, make the Warranty valid if necessary, and to avoid hazards of fatal injuries please read and understand this Manual before using the tool.

Keep this manual for future references.

The illustrations in this manual are for reference only. They might be different from the real tool.

## Use and care recomendations



In order not to damage the product, it is recommended to use a **16 AWG - HEAVY DUTY EXTENSION CORD** (not included).



**ALWAYS USE** the **GUARD. USE THREAD** with diameter from 0.062"



Perform periodic **MAINTENANCE** to your machine (page 10).

## DES-550

Code	•	101263
Description	•	Electric string trimmer/edger
Voltage	•	127 V~
Frequency	•	60 Hz
Current	•	4.3 A
Power	•	550 W
Speed	•	10 000 RPM
Cutting capacity	•	13"
Cutting string diameter	•	1.6 mm
Duty cycle	•	50 minutes work per 20 minutes idle. Maximum six hours daily.
Insulation	•	Class II

Build Quality: Double Insulation.  
Thermal insulation on motor winding: Class E

**⚠ WARNING** Avoid the risk of electric shock or severe injury. When the power cable gets damaged it should only be replaced by the manufacturer or at a  **TRUPER** Authorized Service Center. The build quality of the electric insulation is altered if spills or liquid gets into the tool while in use. Do not expose to rain, liquids and/or dampness.

**⚠ WARNING** Before gaining access to the terminals all power sources should be disconnected.



## Power Requirements

**⚠ WARNING** Tools with double insulation are equipped with a polarized plug (one prong is wider than the other). This plug will only fit in the right way into a polarized outlet. If the plug cannot be introduced into the outlet, reverse the plug. If it still doesn't fit, call a qualified electrician to install for you a polarized outlet. Do not alter the plug in any way. Double insulation eliminates the need of both a grounded third power cord with three prongs or a grounded power connection.

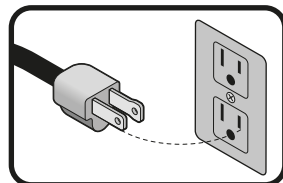

**⚠ WARNING** When using an extension cable, verify the gauge is enough for the power that your product needs. A lower gauge cable will cause voltage drop in the line, resulting in power loss and overheating. The following table shows the right size to use depending on cable's length and the ampere capability shown in the tool's nameplate. When in doubt use the next higher gauge.

Ampere Capacity	Number of Conductors	Extension gauge	
		from 6' m to 49'	higher than 49'
from 0 A and up to 10 A	3 (one grounded)	18 AWG(*)	16 AWG
from 10 A and up to 13 A		16 AWG	14 AWG
from 13 A and up to 15 A		14 AWG	12 AWG
from 15 A and up to 20 A		8 AWG	6 AWG

\* It is safe to use only if the extensions have a built-in artifact for over current protection.

AWG = American Wire Gauge. Reference: NMX-J-195-ANCE

**⚠ WARNING** When operating power tools outdoors, use a  **VOLTECK** grounded extension cable labeled "For Outdoors Use". These extensions are especially designed for operating outdoors and reduce the risk of electric shock.





# General Power Tool Safety Warnings



**⚠ WARNING! Read carefully all safety warnings and instructions listed below.** Failure to comply with any of these warnings may result in electric shock, fire and / or severe damage. **Save all warnings and instructions for future references.**

## Work area

**Keep your work area clean, and well lit.**

Cluttered and dark areas may cause accidents.



**Never use the tool in explosive atmospheres, such as in the presence of flammable liquids, gases or dust.**

Sparks generated by power tools may ignite the flammable material.



**Keep children and bystanders at a safe distance while operating the tool.**

Distractions may cause losing control.



## Electrical Safety

**The tool plug must match the power outlet. Never modify the plug in any way. Do not use any adapter plugs with grounded power tools.**

Modified plugs and different power outlets increase the risk of electric shock.



**Avoid body contact with grounded surfaces, such as pipes, radiators, electric ranges and refrigerators.**

The risk of electric shock increases if your body is grounded.

**Do not expose the tool to rain or wet conditions.**

Water entering into the tool increases the risk of electric shock.

**Do not force the cord. Never use the cord to carry, lift or unplug the tool. Keep the cord away from heat, oil, sharp edges or moving parts.**

Damaged or entangled cords increase the risk of electric shock.

**When operating a tool outdoors, use an extension cord suitable for outdoor use.**

Using an adequate outdoor extension cord reduces the risk of electric shock.

**If operating the tool in a damp location cannot be avoided, use a ground fault circuit interrupter (GFCI) protected supply.**

Using a GFCI reduces the risk of electric shock.

## Personal safety

**Stay alert, watch what you are doing and use common sense when operating a tool. Do not use a power tool while you are tired or under the influence of drugs, alcohol or medication.**

A moment of distraction while operating the tool may result in personal injury.

**Use personal protective equipment. Always wear eye protection.**

Protective equipment such as safety glasses, anti-dust mask, non-skid shoes, hard hats and hearing protection used in the right conditions significantly reduce personal injury.



**Prevent unintentional starting up. Ensure the switch is in the "OFF" position before connecting into the power source and / or battery as well as when carrying the tool.**

Transporting power tools with the finger on the switch or connecting power tools with the switch in the "ON" position may cause accidents.

**Remove any wrench or vice before turning the power tool on.**

Wrenches or vices left attached to rotating parts of the tool may result in personal injury.

**Do not overreach. Keep proper footing and balance at all times.**

This enables a better control on the tool during unexpected situations.

**Dress properly. Do not wear loose clothing or jewelry. Keep hair, clothes and gloves away from the moving parts.**

Loose clothes or long hair may get caught in moving parts.



**If you have dust extraction and recollection devices connected onto the tool, inspect their connections and use them correctly.**

Using these devices reduce dust-related risks.

## Power Tools Use and Care

**Do not force the tool. Use the adequate tool for your application.**

The correct tool delivers a better and safer job at the rate for which it was designed.



**Do not use the tool if the switch is not working properly.**

Any power tool that cannot be turned ON or OFF is dangerous and should be repaired before operating.

**Disconnect the tool from the power source and / or battery before making any adjustments, changing accessories or storing.**

These measures reduce the risk of accidentally starting the tool.

**Store tools out of the reach of children. Do not allow persons that are not familiar with the tool or its instructions to operate the tool.**

Power tools are dangerous in the hands of untrained users.



**Service the tool. Check the mobile parts are not misaligned or stuck. There should not be broken parts or other conditions that may affect its operation. Repair any damage before using the tool.**

Most accidents are caused due to poor maintenance to the tools.



**Keep the cutting accessories sharp and clean.**

Cutting accessories in good working conditions are less likely to bind and are easier to control.

**Use the tool, components and accessories in accordance with these instructions and the projected way to use it for the type of tool when in adequate working conditions.**

Using the tool for applications different from those it was designed for, could result in a hazardous situation.

## Service

**Repair the tool in a  TRUPER Authorized Service Center using only identical spare parts.**

This will ensure that the safety of the power tool is maintained.

**Children or people with reduced physical, sensory or mental capabilities shall not operate the tool, neither inexperienced people or without knowledge in the use of the tool, unless supervised by a person responsible of their safety or if receiving previous instructions about the tool operation.**

Children shall be kept under supervision to double-check they will not play with the tool. Tight supervision shall be used with children or disabled persons to prevent from using or being close to any household tool.



## Before operating the trimmer

**⚠ CAUTION** • It is recommended that the trimmer is connected by means of a Residual current device (RCD) with a cutting current no higher than 30 mA.

- Read the instructions carefully. Familiarize yourself with the controls and the proper use of the equipment.
- Keep the additional flexible cord away from the cutting elements.
- Wear eye protection.
- Never allow children or people not familiarized with the equipment to use it.
- Do not use the equipment while there people around, especially children or pets.
- Use the equipment only in daylight or where there is good lighting.
- Never operate the machine with a damaged guard or protection, or without guards and protections in place
- Switch on the motor only when the hands and feet are away from the cutting elements.
- Never assemble metal cutting elements.
- Use only replacement parts and accessories recommended by the manufacturer.
- Always disconnect the device from the power supply when not in use.
- Disconnect the equipment from the power source before doing maintenance or cleaning.
- Inspect and provide regularly maintenance to the unit. The equipment must only be repaired in an authorized distribution center.
- Take care of not hurting with the knives used for adjusting the line length. After placing a new cutting line, put the tool back to its normal position before turning it on again.
- Make sure that the ventilation holes are free of waste.
- When not using the device, keep it away from the reach of the infants.

**⚠ CAUTION** • Carefully inspect the area to cut, to avoid any obstacle and remove any foreign object that could be thrown out by the trimmer. Otherwise, you could cause an accident and the useful life of the trimmer can be reduced.

**⚠ CAUTION** • The area to cut should be well illuminated.

**⚠ CAUTION** • Double-check every part in the trimmer is in excellent working condition and the cutting string is correctly set. Inspect the ventilation slots are free of debris. Refrain from using the trimmer if the guard is damaged or has missing parts.

**⚠ WARNING** • Use only the original nylon string and for no reason at all replace it with metal string.

- For best results it is recommended to use only original thread replacements such as: HTA-65B, HIDE-65P, HTA-65 and HDU-15-65 Truper® brand.

• Remember this tool is designed to cut grass as indicated in this Manual. For no reason at all it can be used for a different purpose.

**⚠ WARNING** • To prevent from electric shock refrain from working in humid environments, such as when is raining or there is dew on the grass.



## While operating the trimmer

**⚠ CAUTION** • Do not operate the trimmer close to passersby, children or animals.

**⚠ WARNING** • Never set the cutting head above 11.8" of height and do not aim it towards people or animals.

**⚠ WARNING** • Use the trimmer only to cut at ground level. For no reason at all use it to cut vegetation on stones or walls.

**⚠ CAUTION** • Do not walk on gravel when the trimmer is running. The cutting string might shoot out gravel pieces towards the user or passersby causing injuries.

**⚠ CAUTION** • To prevent the cutting string damaging the cable always keep the trimmer's power cable visible.

**⚠ WARNING** • Refrain from putting your hands or feet close to the cutting head while the tool is running.

**⚠ DANGER** • Eln case of working close to transit roads stop cutting until there are no vehicles on sight. The trimmer could shoot debris towards the moving vehicles, thus causing a severe accident.

## After operating the trimmer

**⚠ WARNING** • Cutting elements continue to rotate after the engine is turned off

- Do not try to stop the cutting string's rotating movement in any other way than releasing the switch. Wait until the spool comes to a complete stop after releasing the switch, this takes a few seconds.

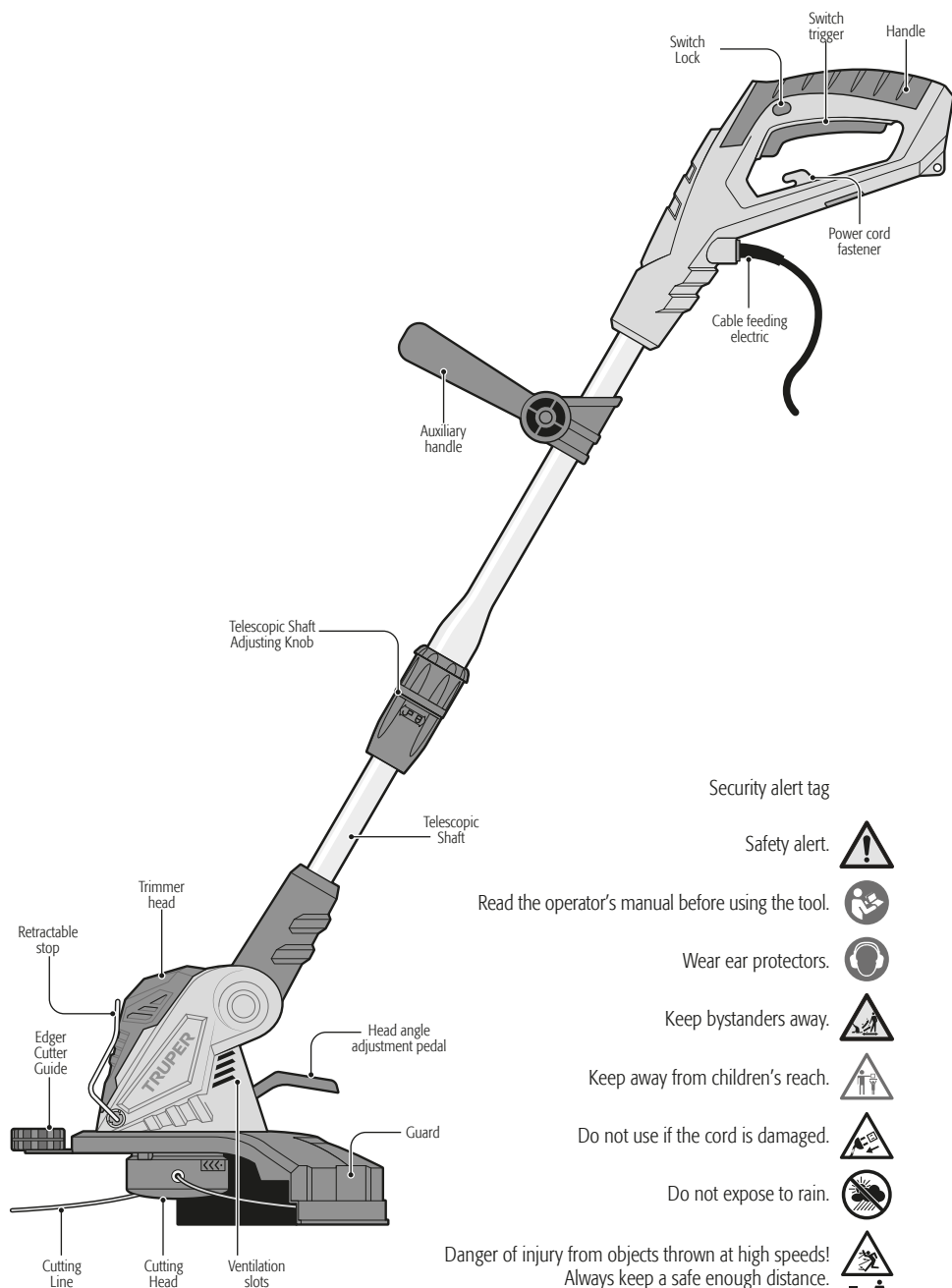

Security alert tag

Safety alert.



Read the operator's manual before using the tool.



Wear ear protectors.



Keep bystanders away.



Keep away from children's reach.



Do not use if the cord is damaged.



Do not expose to rain.



Danger of injury from objects thrown at high speeds!  
Always keep a safe enough distance.



The equipment continues to rotate after turning it off, keep your hands at a safe distance until the machine comes to a complete stop.



## Guard

- To assemble and disassemble the guard tighten or loosen the four screws **(A)** in the bottom of the guard.

**CAUTION** • Operating the tool with the guard removed increases the risk of accidents and damage to the tool.

**CAUTION** • Turn off and disconnect the trimmer before assembling or disassembling the guard.

## Guide to Trim Edges

- To assemble and disassemble the edger guide tighten or loosen the two screws **(B)** in the bottom of the guide.

**CAUTION** • Turn off and disconnect the trimmer before assembling or disassembling the guide.

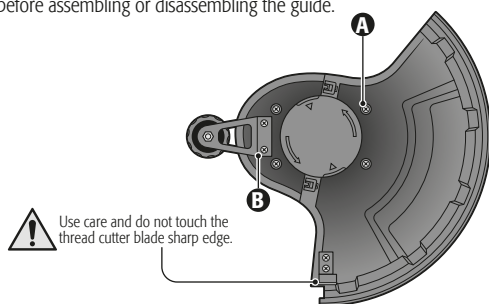

## Adjusting the auxiliary handle

- Place the auxiliary handle **(D)** on the base **(E)**
- Insert the screw into the hole of the handle **(D)** and the base **(E)** and secure the assembly by threading the knob **(G)**
- Place the auxiliary handle on the main handle housing **(D')**.
- Insert the screw into the handle and housing hole **(E)**.
- Adjust the auxiliary handle to the desired angle **(F)**.
- Tighten the knob **(G)** to lock the handle's position.

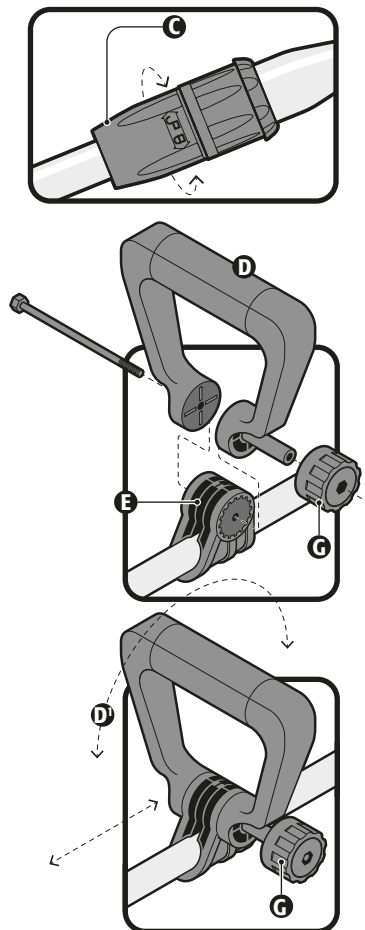

## Head tilt Adjustment

- Step on the pedal **(H)** and tilt the head to the best position for the work to be done.

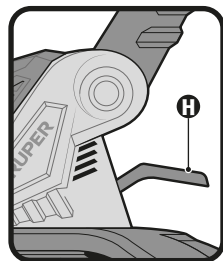
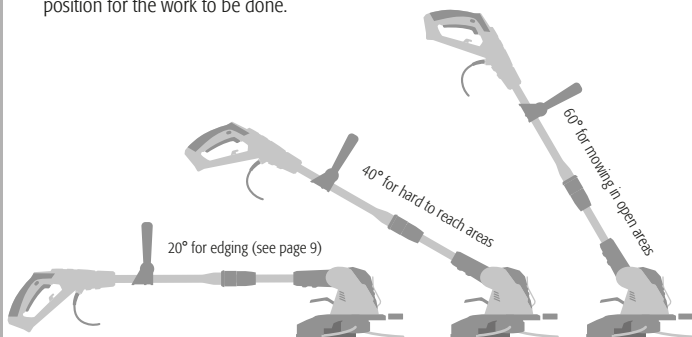

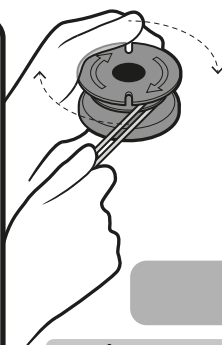
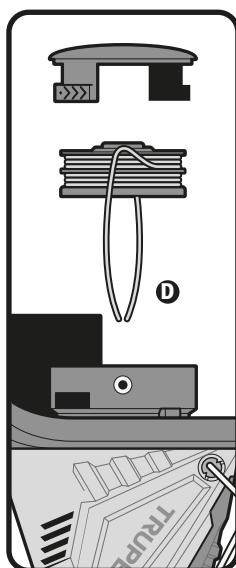
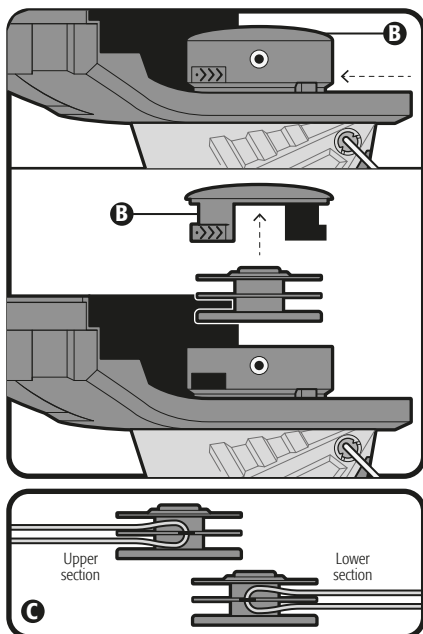

## Cutting string spool

- The trimmer shall be off and disconnected. Remove the spool-retaining cap (B) pressing towards the side tabs. Pull the cap upward.
- Remove the empty spool. Double check is clean and has no damaged or worn parts.
- Cut a 5.5 m long piece of cutting wire
- Bend the thread to half its length, and insert it into the notch (C).
- Hold both lines and spin in the direction indicated in the spool with an arrow. Double check each length of line is spun in their respective section (upper and lower). Do not spin too much line. After spinning there shall be a minimum 1/4" distance between the spool edge and the spun line.
- Leave a length of approximately 6" of both lines. Insert the line from the upper section in one of the notches in the spool cover. Give the spool another half-a-turn and insert the lower section line in the opposite notch in the spool cover.

This is done to prevent the line to get loose while installing the spool in the brush trimmer. Later, you will release the lines from the notches.

- Set back the spool in the cutting head (D). Pass the ends of each line through the cover orifices. If in this step, the line gets released or tangled spin it again in the spool and secure it in the notches.

**CAUTION** • Pull hard and outward both cutting string ends to release them from the grooves in the spool upper part.

- When installing a new spool release the ends of the line from the notches and unroll approximately 6" of both lines to secure them back in the notches before setting the spool in its cover.

## Start up

### Turning on

- Make a loop in the feeding cable (A) and pass it through the string trimmer handle lower orifice.
- Pass one end of the extension (Not included) through the loop and then, connect to the power cable (B). Using a heavy duty extension is recommended (not included).
- Tighten the extension cable perfectly and connect to a power outlet with the specified voltage for the string trimmer.
- To start the string trimmer, press the switch lock (C). Then press the trigger (D). To shut off the string trimmer release the trigger.

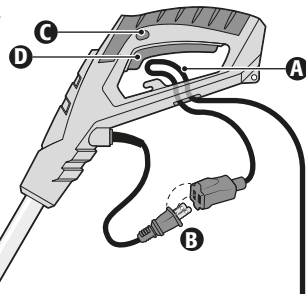



## Operation

**⚠ CAUTION** • Remember that the trimmer users are responsible of their safety as well as the safety of people near the work area. Follow all the safety standards (pages 4 and 5) before, during and after operating the tool.

- Keep a balanced stance and good footing with both feet on the ground.
- Hold firmly the trimmer in front of you. Keep your right hand on the handle and at your hip's height. The left hand on the auxiliary handle to align the tool with your body and pointing the cutting head downwards and away from your feet.

**⚠ DANGER** • Do not turn on or operate the trimmer in a position different from the standard.

- Turn on the trimmer and cut from left to right while rotating your waist and keeping the tool's position.

**NOTICE** • The trimmer is built with as self-feeding head. Hitting the head to make the cutting string advance will make the trimmer warranty void.

- As the cut is being done the cutting string will wear out and will eventually fall apart.

To release more string from the spool, operate the trimmer, and release the switch trigger. Wait two seconds and press the switch trigger. The cutting string becomes larger approximately 1/4" every time the trigger switch is on and off, until cutting string reaches the guard blade length.

- To cut shrubs or tall grass make it gradually. Do not try to cut in one pass from its base. Residues may clog the cutting head or cause losing control on the trimmer.
- Lower the retractable stop (A) to avoid damaging branches or walls while cutting.

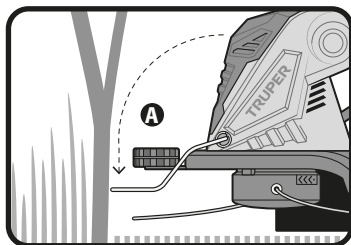
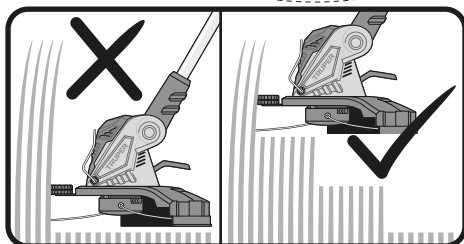
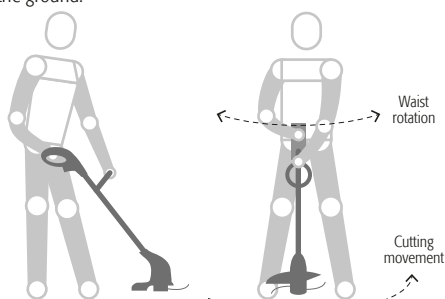

## Edge Trimming

- To trim grass edges in the curbs or paths, turn the brush trimmer head 180° and use the edge trimmer guide.
- Pull adjustment knob (B) towards handle and turn top of brush cutter 180° clockwise.
- Adjust the head to 20° (see head tilt adjustment).
- Place the de-looping guide wheel on sidewalks and guide the string across the length of the lawn.

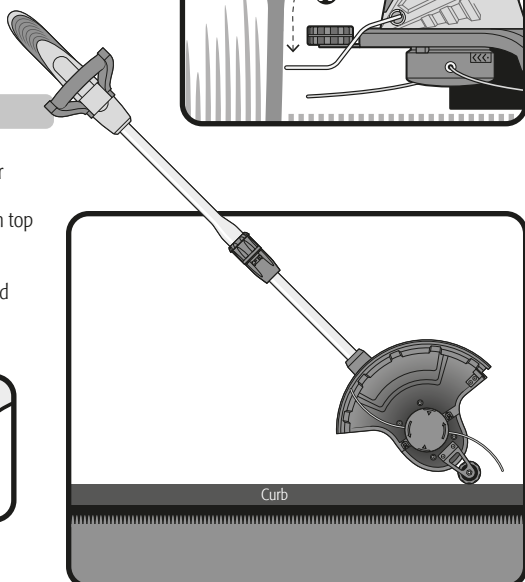
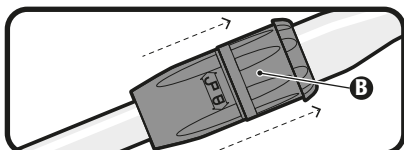



## Cleaning

- Cleaning after each use will keep the trimmer in the best of working conditions and will lengthen its useful life.
- To clean use a cloth dampened with hot water and a soft brush.
- After each use disassemble all the tool parts. Remove all grass particles and ground stuck in it. Use special care with the cutting string spool and its slots, also the guard.
- Clean thoroughly the trimmer ventilation slots so there is no grass or dirt obstructing.

## Storage

- To prevent rust clean the tool before storing.
- Store the trimmer in a dry temperate place away from sunlight (preferably in a dark place) and away from children reach.
- Prevent from storing the trimmer in plastic bags. Otherwise the humidity generated could damage it.
- Do not store the trimmer with the guard against the floor. It could get distorted. The trimmer shall be stored hanging from the upper handle preventing the guard to touch the floor.

## Carbon brush replacement

- Carbon brushes should be checked periodically.
- When one or both carbon brushes show signs of wear go to a  **TRUPER®** Authorized Service center to have both carbon brushes replaced. When replaced, see if the new carbon brushes move freely in the carbon brush housing. Ask to turn on the tool during five minutes to make the contact in the carbon brushes and the commutator even.
- Use only original  **TRUPER®** spare carbon brushes, designed specifically with the right strength and electric resistance for each type of motor. Carbon brushes with different specifications may damage the motor.
- When replacing carbon brushes, always change both.

## Service

- All repairs and service should be made only in a  **TRUPER®** Certified Service Center.

## Environment protection

- After the tool has reached its full duty life all discarded material such as joints, damaged parts or the tool itself shall not be handled as garbage. Take to a recycling center to be adequately disposed off and taking care of all the environmental standards.

# Troubleshooting

## Problem

## Cause

## Solution

The cutting string is not advancing when release and press the switch trigger.

- The string has stuck itself.
- There is not enough string in the spool.
- The string is tangled in the spool.
- The string has not been liberated from the spool grooves.

- Lubricate the cutting head with a  **TRUPER®** aerosol silicon lubricant.
- Set new string in the spool (see page 7).
- Turn off the trimmer and wind again the string onto the spool (see page 7).
- Turn off the trimmer and pull both cutting strings ends to release them.

The motor will not start.

- The extension cable is not well connected.
- The power circuit breaker blew.

- Connect the extension cable correctly.
- Check the power circuit breaker .

Grass gets tangled around the lower spindle and the cutting head.

- You are cutting grass too high from the ground level on.
- Cut grass gradually as explained in page 8.

In the event of any problem contacting a Truper Authorized Service Center, please see our webpage [www.truper.com](http://www.truper.com) to get an updated list, or call our toll-free numbers **800 690-6990** or **800 0187-8737** to get information about the nearest Service Center.

## AGUASCALIENTES

### DE TODO PARA LA CONSTRUCCIÓN

GRAL. BARRACÁN #1201, COL. GREMIAL, C.P. 20030, AGUASCALIENTES, AGS. TEL.: 449 994 0537

## BAJA CALIFORNIA

### SUCURSAL TIJUANA

AV. LA ENCANTADA, LOTE #5, PARQUE INDUSTRIAL EL FLORIDO II, C.P. 22244, TIJUANA, B.C. TEL.: 664 969 5100

## BAJA CALIFORNIA SUR

### FIX FERRETERÍAS

FELIPE ÁNGELES ESQ. RUIZ CORTÍNEZ S/N, COL. PUEBLO NUEVO, C.P. 23670, CD. CONSTITUCIÓN, B.C.S. TEL.: 613 132 1115

## CAMPECHE

### TORNILLERÍA Y FERRETERÍA AAA

AV. ÁLVARO OBREGÓN #324, COL. ESPERANZA C.P. 24080 CAMPECHE, CAMP. TEL.: 981 815 2808

## CHIAPAS

### FIX FERRETERÍAS

AV. CENTRAL SUR #27, COL. CENTRO, C.P. 30700, TAPACHULA, CHIS. TEL.: 962 118 4083

## CHIHUAHUA

### SUCURSAL CHIHUAHUA

AV. SILVESTRE TERRAZAS #128-11, PARQUE INDUSTRIAL BAFAR, CARRETERA MÉXICO CUAUHTÉMOC, C.P. 31415, CHIHUAHUA, CHIH. TEL.: 614 434 0052

## CIUDAD DE MÉXICO

### FIX FERRETERÍAS

EL MONSTRUO DE CORREGIDORA, CORREGIDORA # 22, COL. CENTRO, C.P. 06060, CUAUHTÉMOC, CD.MX. TEL.: 55 5522 5051 / 5522 4861

## COAHUILA

### SUCURSAL TORREÓN

CALLE METAL MECÁNICA #280, PARQUE INDUSTRIAL ORIENTE, C.P. 27278, TORREÓN, COAH. TEL.: 871 209 68 23

## COLIMA

### BOMBAS Y MOTORES BYMTESA DE MANZANILLO

BLVD. MIGUEL DE LA MADRID #190, COL. 16 DE SEPTIEMBRE, C.P. 28239, MANZANILLO, COL. TEL.: 314 352 1986 / 352 8013

## DURANGO

### TORNILLOS ÁGUILA, S.A. DE C.V.

MAZURIO #200, COL. LUIS ECHEVERRÍA, DURANGO, DGO. TEL.: 618 817 1946 / 618 818 2844

## ESTADO DE MÉXICO

### SUCURSAL CENTRO JILOTEPEC

PARQUE INDUSTRIAL # 1, COL. PARQUE INDUSTRIAL JILOTEPEC, JILOTEPEC, EDO. DE MÉX. C.P. 54257 TEL.: 761 782 9101 EXT. 5728 Y 5102

## GUANAJUATO

### CÍA. FERRETERA NUEVO MUNDO S.A. DE C.V.

AV. MÉXICO - JAPÓN #225, CD. INDUSTRIAL, C.P. 38010, CELAYA, GTO. TEL.: 461 617 7578 / 79 / 80 / 88

## GUERRERO

### CENTRO DE SERVICIO ECLIPSE

CALLE PRINCIPAL MZ.1 LT. 1, COL. SANTA FE, C.P. 39010, CHILPANCINGO, GRO. TEL.: 747 478 5793

## HIDALGO

### FERREPRECIOS S.A. DE C.V.

LIBERTAD ORIENTE #304 LOCAL 30, INTERIOR DE PASAJE ROBLED0, COL. CENTRO, C.P. 43600, TULANCINGO, HGO. TEL.: 775 755 6615 / 775 755 6616

## JALISCO

### SUCURSAL GUADALAJARA

AV. ADOLFO B. HORN # 6800, COL. SANTA CRUZ DEL VALLE, C.P.: 45655, TLAJOMULCO DE ZUÑIGA, JAL. TEL.: 33 3606 5285 AL 90

## MICHOACÁN

### FIX FERRETERÍAS

AV. PASEO DE LA REPÚBLICA #3140-A, COL. EX-HACIENDA DE LA HUERTA, C.P. 58050, MORELIA, MICH. TEL.: 443 334 6858

## MORELOS

### FIX FERRETERÍAS

CAPITÁN ANZURES #95, ESQ. JOSÉ PERDIZ, COL. CENTRO, C.P. 62740, CUAUTLA, MOR. TEL.: 735 352 8931

## NAYARIT

### HERRAMIENTAS DE TEPEC

MAZATLAN #117, COL. CENTRO, C.P. 63000, TEPEC, NAY. TEL.: 311 258 0540

## NUEVO LEÓN

### SUCURSAL MONTERREY

CARRETERA LAREDO #500, 18 MONTERREY PARKS, COLONIA PUERTA DE ANÁHUAC, C.P. 66052, ESCOBEDO, NUEVO LEÓN, TEL.: 81 8352 8791 / 81 8352 8790

## OAXACA

### FIX FERRETERÍAS

AV. 20 DE NOVIEMBRE #910, COL. CENTRO, C.P. 68300, TUXTEPEC, OAX. TEL.: 287 106 3092

## PUEBLA

### SUCURSAL PUEBLA

AV. PERIFÉRICO #2-A, SAN LORENZO ALMECATLA, C.P. 72710, CUAUTLACINGO, PUE. TEL.: 222 282 8282 / 84 / 85 / 86

## QUERÉTARO

### ARU HERRAMIENTAS S.A. DE C.V.

AV. PUERTO DE VERACRUZ #110, COL. RANCHO DE ENMEDIO, C.P. 76842, SAN JUAN DEL RÍO, QRO. TEL.: 427 268 4544

## QUINTANA ROO

### FIX FERRETERÍAS

CARRETERA FEDERAL MZ. 46 LT. 3 LOCAL 2, COL. EJIDAL, C.P. 77710 PLAYA DEL CARMEN, Q.R. TEL.: 984 267 3140

## SAN LUIS POTOSÍ

### FIX FERRETERÍAS

AV. UNIVERSIDAD #1850, COL. EL PASEO, C.P. 78320, SAN LUIS POTOSÍ, S.L.P. TEL.: 444 822 4341

## SINALOA

### SUCURSAL CULIACÁN

AV. JESÚS KUMATE SUR #4301, COL. HACIENDA DE LA MORA, C.P. 80143, CULIACÁN, SIN. TEL.: 667 173 9139 / 173 8400

## SONORA

### FIX FERRETERÍAS

CALLE 5 DE FEBRERO #517, SUR LT. 25 MZ. 10, COL. CENTRO, C.P. 85000, CD. OBREGÓN, SON. TEL.: 644 413 2392

## TABASCO

### SUCURSAL VILLAHERMOSA

CALLE HELIO LOTES 1, 2 Y 3 MZ. #1, COL. INDUSTRIAL, 2A ETAPA, C.P. 86010, VILLAHERMOSA, TAB. TEL.: 993 353 7244

## TAMAULIPAS

### VM ORINGS Y REFACCIONES

CALLE ROSITA #527 ENTRE 20 DE NOVIEMBRE Y GRAL. RODRÍGUEZ, FRACC. REYNOSA, C.P. 88780, REYNOSA, TAMS. TEL.: 899 926 7552

## TLAXCALA

### SERVICIOS Y HERRAMIENTAS INDUSTRIALES

PABLO SIDAR #132, COL. BARRIO DE SAN BARTOLOMÉ, C.P. 90970, SAN PABLO DEL MONTE, TLAX. TEL.: 222 271 7502

## VERACRUZ

### LA CASA DISTRIBUIDORA TRUPER

BLVD. PRIMAVERA ESQ. HORTENSIA S/N, COL. PRIMAVERA C.P. 93308, POZA RICA, VER. TEL.: 782 823 8100 / 826 8484

## YUCATÁN

### SUCURSAL MÉRIDA

CALLE 33 #600 Y 602, LOCALIDAD ITZINCAB Y Mulsay, MPIO. UMAN, C.P. 97390, MÉRIDA, YUC. TEL.: 999 912 2451

Code	Model	Brand
101263	DES-550	 <b>TRUPER®</b>

This product is guaranteed for 2 years. To make the warranty valid or purchase parts and components you must present the product in Corregidora 22, Col. Centro, Alc. Cuauhtémoc, CDMX C.P. 06060 or at the establishment where you purchased it, or at any Truper® Service Center listed in the annex to the warranty policy and/or in [www.truper.com](http://www.truper.com). Transportation costs resulting from compliance of this warranty will be covered by  **TRUPER®**

For questions or comments, call **800-690-6990**. Made in China. Imported by Truper, S.A. de C.V. Parque Industrial 1, Parque Industrial Jilotepec, Jilotepec, Edo. de Méx. C.P. 54257

Stamp of the business. Date of purchase:

